

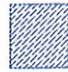

LAND AT ROTHERHITHE STREET/SALTER ROAD LONDON SE16
CABINET REPORT 19 OCTOBER

APPENDIX TWO

-  proposed building footprint
-  London Borough of Southwark freehold, long term lease to Dockland Settlements (proposed)
-  Dockland Settlements freehold

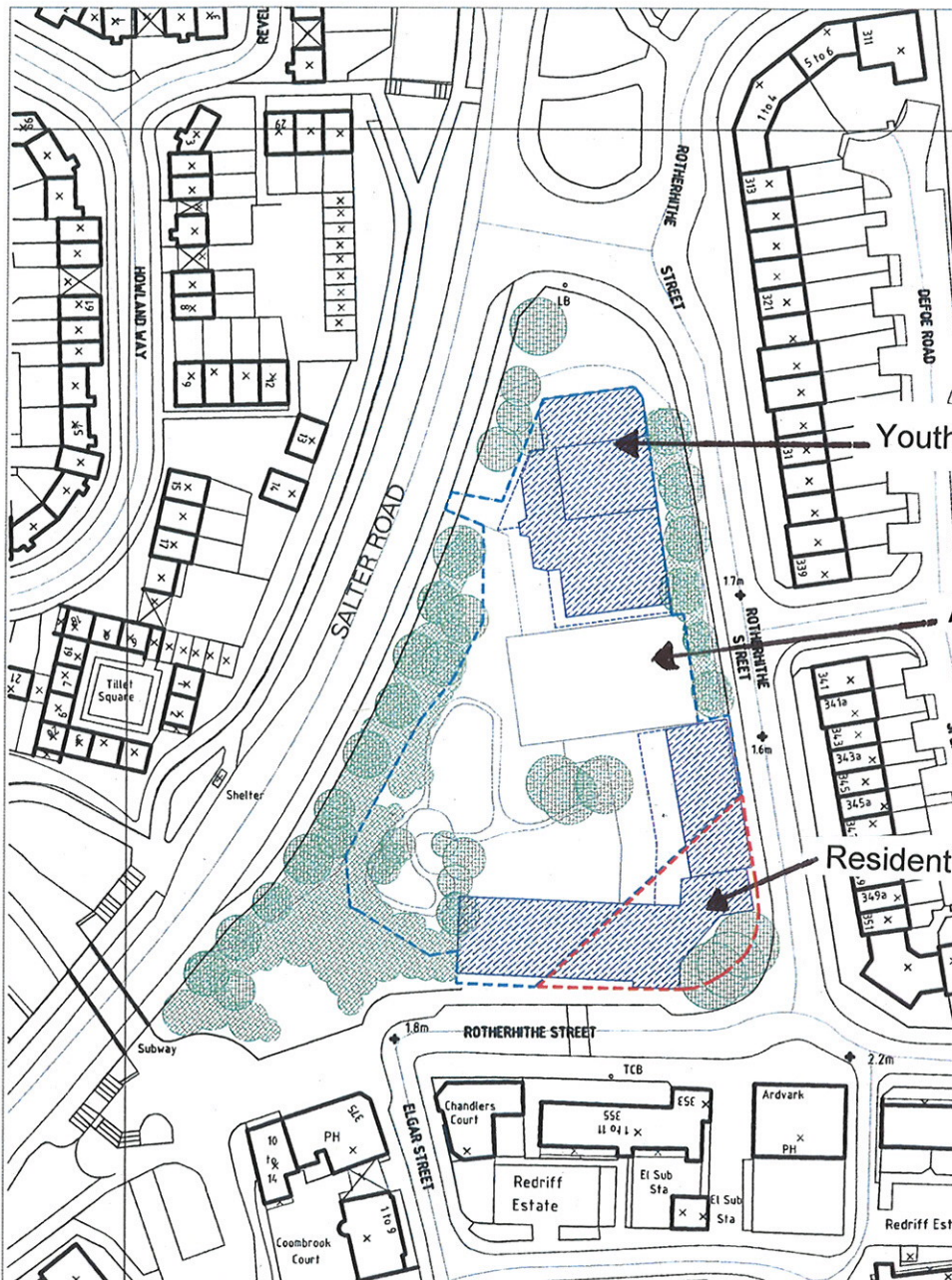

 Proposed site plan (1:1250)